

QUARTER AT THE HIRSCHBERG

SUFFICIENT, COMMUNITY BASED, GREEN

assignment cooperative planning workshop **location** Biberach, Germany **size** 11 ha **client** Municipality Biberach **services** urban development concept for a residential area with 300 units at Hirschberg **status** completed, 2022 **team** Verena Brehm, Lukas Hegele, Lisa Iglseider, Ricarda Roloff **cooperation** NSP Landschaftsarchitekten

The former site of the district clinic in Biberach is an urban area in a central location in the town and offers a rare opportunity to create an exemplary and forward-looking residential quarter. The site is characterized by its hillside location and impressive tree population, which presents special challenges and opportunities for sustainable development.

The aim of our design is to create a diverse residential quarter that offers a home to many residents. Particular emphasis is placed on affordable and diverse living as well as the creation of a car-free interior. Efficient use of the land and the promotion of a vibrant community are at the heart of the planning. Our approach deliberately disregards the requirements of the competition by avoiding the construction of detached single-family homes. Instead, so-called neighborhood islands will be created, integrating different forms of housing and comprising 40 to 60 residential units per island. These islands are embedded in a communal open space designed to promote social interaction and encourage encounters - the so-called commons.

At the center of each island is a car-free meeting place for residents, while the private gardens are oriented towards the outside. The communal open space offers play areas, meeting points and public green areas. The adjacent wooded slope remains largely natural and offers space for vegetation, orchards and wildflowers as well as a picturesque view of the surrounding area. This innovative residential concept is intended to provide a sustainable and social response to the housing needs of the city of Biberach by creating diverse, green and community-oriented living options in a central location.



Concept sketch: New neighborhood at Hirschberg

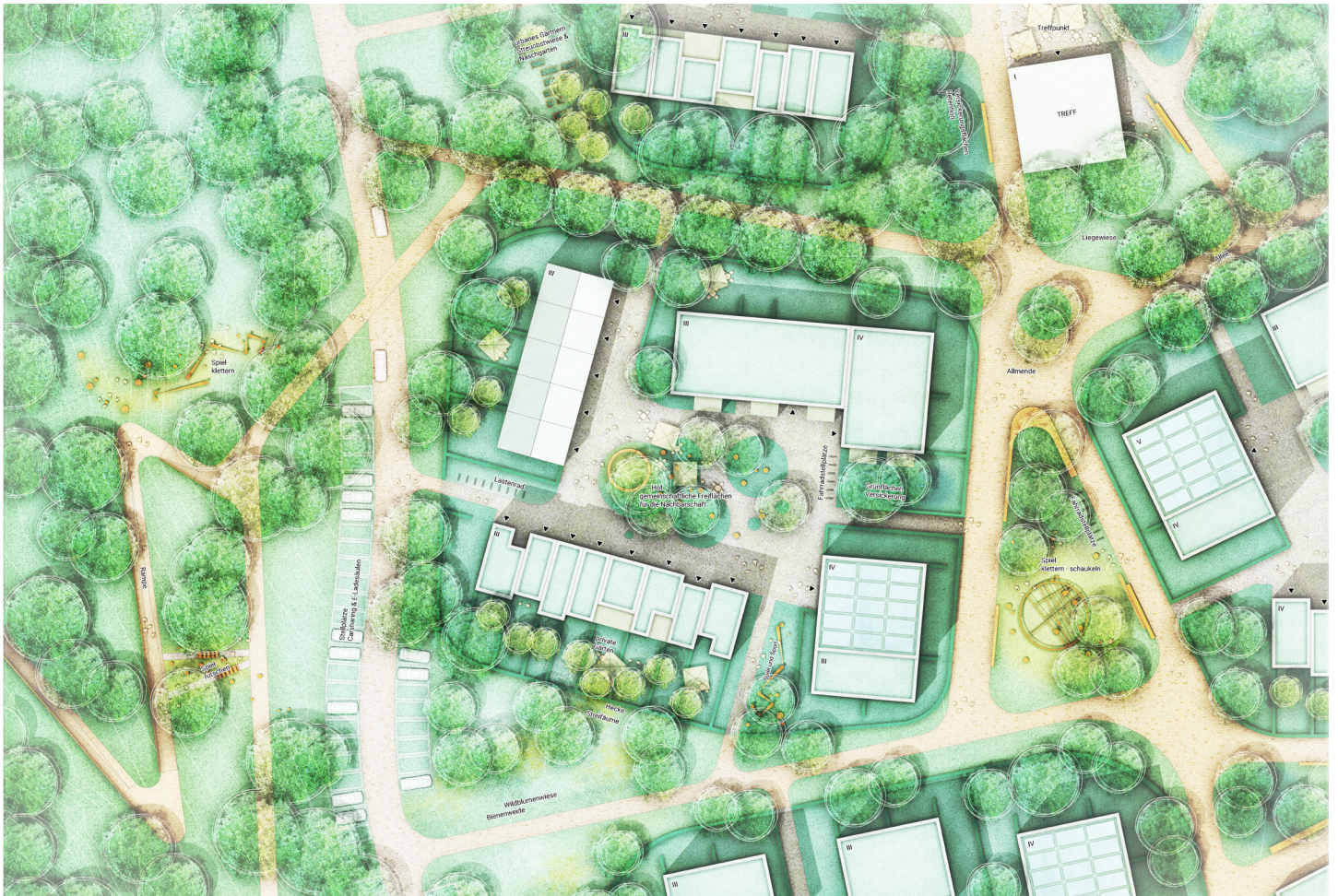

Zoom In: Neighborhood court with surrounding gardens and the commons



Floorplan: the commons connect the neighborhoods



The neighborhood center in the commons



The neighborhood court as a meeting point



picture subtitle right

Playgrounds and green spaces in the commons